

WOOD STUD ANCHOR

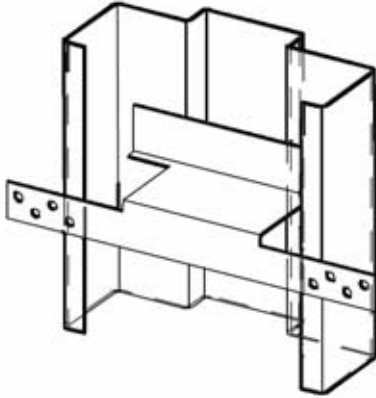

- | | |
|------------------------------|--|
| 1. Material | 16 Ga. Galvannealed Steel |
| 2. Supplied | Welded in prior to shipment |
| 3. Applicable Frame Series: | F, FN, MU, FE, DE |
| 4. Profile variations: | DR – Double Rabbet (equal & unequal) CO – Cased Open NOTE – profile must have a return |
| 5. Frame depths | All frame depths |
| 6. Face variations | Fits all face variations Ordered specifically to fit face |
| 7. Frame attachment: | Must be welded to frame |
| 8. Application: | Arrives at jobsite welded into frame |
| 9. Wall construction: | Wood stud walls |
| 10. Fire label applications: | UL/WH 3 hour max. |
| 11. Base anchor | Additional wood stud anchor used as the sill anchor |

CLOSED STEEL STUD ANCHOR

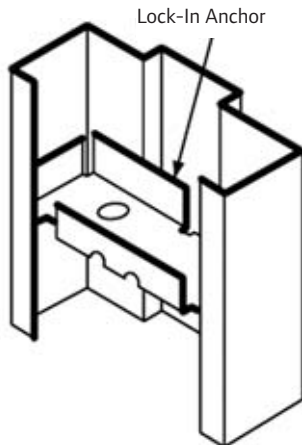

- | | |
|------------------------------|--|
| 1. Material | 18 Ga. Galvannealed Steel |
| 2. Supplied | Shipped loose for field installation |
| 3. Applicable Frame Series: | F |
| 4. Profile variations: | DR – Double Rabbet (equal & unequal) CO – Cased Open NOTE – profile must have a return |
| 5. Frame depths | 4-3/4", 5-3/4", 6-3/4", 7-3/4", 8-3/4" - non-adjustable |
| 6. Face variations | 2" only |
| 7. Frame attachment: | Lock-in |
| 8. Application: | Ship loose to jobsite, field installed |
| 9. Wall construction: | Closed steel stud walls |
| 10. Fire label applications: | UL/WH 3 hour max. |
| 11. Base anchor | See #2.4.12 for base anchor details |

CLOSED STEEL STUD ANCHOR

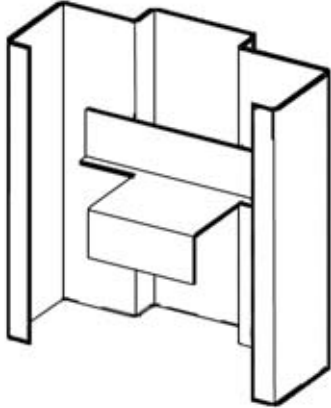

- | | |
|------------------------------|--|
| 1. Material | 16 Ga. Galvannealed Steel |
| 2. Supplied | Welded in prior to shipment |
| 3. Applicable Frame Series: | F, FN, MU, FE, DE |
| 4. Profile variations: | SR – Single Rabbet DR – Double Rabbet (equal & unequal) CO – Cased Open NOTE – profile must have a return |
| 5. Frame depths | All frame depths |
| 6. Face variations | Fits all face variations Ordered specifically to fit face |
| 7. Frame attachment: | Must be welded to frame |
| 8. Application: | Arrives at jobsite welded into frame |
| 9. Wall construction: | Closed steel stud walls |
| 10. Fire label applications: | UL/WH 3 hour max. |
| 11. Base anchor | See #2.4.12 for base anchor details |

CLOSED STEEL STUD ANCHOR

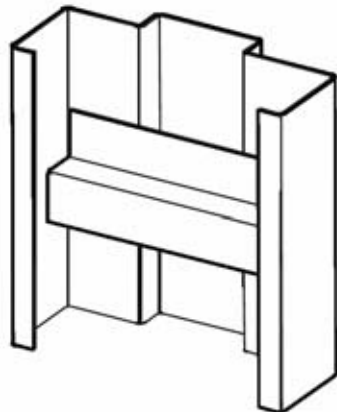

- | | |
|------------------------------|--|
| 1. Material | 16 Ga. Galvannealed Steel |
| 2. Supplied | Welded in prior to shipment |
| 3. Applicable Frame Series: | F, FN, MU, FE, DE |
| 4. Profile variations: | SR – Single Rabbet DR – Double Rabbet (equal & unequal) CO – Cased Open NOTE – profile must have a return |
| 5. Frame depths | All frame depths |
| 6. Face variations | Fits all face variations Ordered specifically to fit face |
| 7. Frame attachment: | Must be welded to frame |
| 8. Application: | Arrives at jobsite welded into frame |
| 9. Wall construction: | Closed steel stud walls |
| 10. Fire label applications: | UL/WH 3 hour max. |
| 11. Base anchor | See #2.4.12 for base anchor details |