



## ABOUT THE PRODUCT:

The HE16 Series Embossed Panel Doors have been specifically designed and tested to meet the performance-based provisions of the Florida Building Code (FBC) and the South Florida Building Code (SFBC) while providing architects, designers and building owners with the broadest choices for their specific applications.

Specifiable options to meet application, specification and performance requirements include mechanical and electrical hardware preparations for exit hardware, cylindrical or mortise single point locks and double locks. No glass lights are allowable.

All HE16 Series doors have been tested to protocols TAS 201, 202 and 203, indicating their ability to withstand the missile impact, structural load and cyclic wind pressure tests prescribed by the Codes.

## INSTALLATION:

1. Installation shall conform to the published Steelcraft installation instructions, ANSI A250.11-2001 (formerly SDI 105) Recommended Erection Instructions for Steel Frames and HMMMA 840.
2. Fire Rated Assemblies must be in accordance with NFPA Pamphlet 80.

The Authority Having Jurisdiction is the final authority in issues related to the installation and use of installed Fire Rated Doors.

## DESIGN PRESSURE RATINGS and HARDWARE CONFIGURATIONS:

Design Pressure Ratings are based on ongoing testing for door, frame and hardware configurations. Applications are limited to the configurations tested. For up to date information, please reference the Steelcraft website at [www.steelcraft.com](http://www.steelcraft.com)

## FEATURES AND BENEFITS:

Steelcraft's HE16 Series Doors offer the following standard unique features, which enhance long term performance and durability:

1. **A-40 Galvannealed Steel** face sheets.
2. **Polystyrene Core** (Standard) - enhances the structural integrity of the door with enhanced thermal capabilities
3. **Full Height, Epoxy Filled Mechanical Interlock Edges** provide structural support and stability the full height of the door edges.
4. **Full Height Lock Side Reinforcement** Channel ensures structural stability and locking hardware functionality under extreme pressure conditions.
5. **Universal Hinge Preparations** (patented) allow for easy field conversion from standard weight .134" (3.3mm) hinges to heavy weight .180" (54.7mm) hinges.
6. **14 Gage [0.067" (1.7mm)] Inverted Top and Bottom Channels** provide stability and protection for the top and bottom edges from abuse.
7. **3/8" undercut** is standard on all H-Series doors, to accommodate hurricane code requirements.
8. **Beveled Hinge and Lock Edges** allow for tighter installation tolerances, ensure easier operation and eliminate binding and sticking.
9. **Screwed-in top caps** provide additional weather protection to exclude water and debris from exterior outswing doors.
10. **Factory Applied Baked-On Rust Inhibiting Primer** paint in accordance with ANSI A250.10-1998 (R2004).

## SPECIFICATION COMPLIANCE:

1. Door construction for Steelcraft HE16 Series Embossed Panel Doors meets the requirements of ANSI A250.8-2003 (SDI 100).
2. Hardware preparations and reinforcements are in accordance with ANSI A250.6-2003. Locations are in accordance with ANSI/DHI A115.
3. Door construction for the HE16 Series Embossed Panel Doors meets ANSI A117.1-1998 (ADA) requirements for minimum 10" (254mm) bottom rail height measured from the floor.
4. Florida Building Code test protocols for high velocity hurricane zones: TAS 201, TAS 202 & TAS 203.

## FLORIDA BUILDING CODE LABEL:

A Florida Building Code Label is applied to all H Series doors. An optional Miami-Dade County label is also available.

## FIRE RATINGS:

Steelcraft HE16 Series Doors meet fire rating requirements.

They are listed for installations requiring compliance to both neutral pressure testing (ASTM E152 and UL-10B) and positive pressure standards (UBC 7-2 and UL-10C).

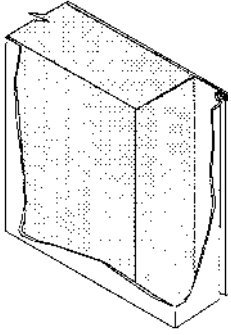

### Insulated Core

- 1 pound (453.6g) per ft<sup>3</sup> density slab
- Preferred for extreme temperature variations
- Laminated to both face sheets with contact adhesive
- Assembled door is run through high pressure pinch rollers achieving ultimate bond

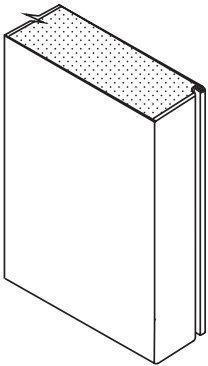

### Standard Premium Edge Construction

- Beveled hinge & lock edges
- Full height mechanical interlock with adhesive
- Visible edge seam standard
- Seamless edge optional

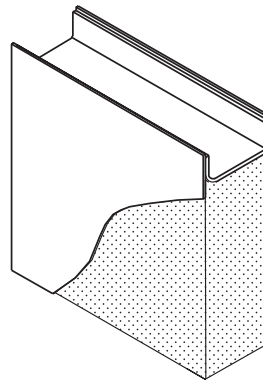

### Standard Rigid 14 gage End Channel Construction

- 14 gage inverted galvanized top & bottom channels
- Projection welded to both face sheets
- Optional 24 gage galvanized top caps

### Door Application and Usage

Series	Steel Thickness	Opening	Usage Frequency <sup>1</sup>	
HE16	16 Ga (1.3 mm)	Exterior - Galvanized Steel	Extra Heavy Duty	Extra Heavy Commercial & Institutional applications with potential of very high use

**Standard Hardware Preparations**

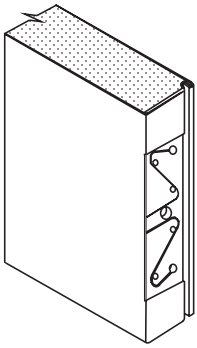

**Standard Mortise Hinge Prep**  
4-1/2" x .134" or  
4-1/2" x .180"

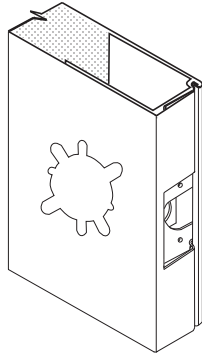

**61L Lock Preparation**

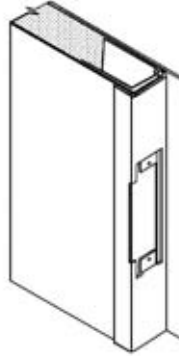

**Inactive Leaf:  
ASA Strike Preparation  
and Astragal**

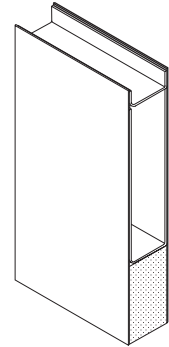

**Optional 14 Gage  
[0.067" (1.7mm)]  
Closer Reinforcement**

**Standard: mortised and reinforced for**

- Patented Universal hinge preparations allow for easy field conversion from standard 4-1/2" (114mm) x .134" (3.3mm) standard weight hinges to 4-1/2" (114mm) x .180" (4.7mm) heavy weight hinges. Optional hinge preparation for 5" (127mm) x .146" (3.7mm) standard weight hinges or for 5" (127mm) x .190" (4.8mm) heavy weight hinges is also available.
- The cylindrical 161, 61L and mortise 86 lock preps are the most commonly used active leaf preparations. The 4-7/8" (124mm) strike prep is the most commonly used inactive leaf preparation.
- Optional reinforcements for surface closers are available.

**SDI Conversion Chart**

Steelcraft product selection for HE Series Doors has been matched to SDI designations for Level and Model. Recommended minimum frame gage also applies to the frequency of operation of the opening.

**Door Sizes and ANSI A250.8 Conversions**

Series	ANSI A250.8 - SDI 100			Edge Construction Options	Maximum Sizes		Recommended Gage of Frame
	Level	Model	Description		Single	Pair	
<b>Level 3 - Extra Heavy Duty Commercial &amp; Institutional</b>							
HE16	3	1	Full Flush	Visible	3'-0" x 8'-0"	6'-0" x 8'-0"	14 Gage [0.067" (1.7mm)]
HEF16		2	Seamless	Epoxy Filled	914mm x 2438mm	1829mm x 2438mm	16 Gage [0.053" (1.3mm)]

**Code Compliance**

- Florida Building Code test protocols for high velocity hurricane zones: TAS 201, TAS 202 & TAS 203.
  - A mylar Florida Building Code label is included as standard
  - Optional mylar Miami-Dade County label

### DOOR EDGE CONSTRUCTION:

Optional Edge Seams available in the L Series doors:

- a. H - Standard feature includes visible edge seams with full height interlocked edges.
- b. HF - the mechanical edge seam is filled and finished prior to applying the factory primer.

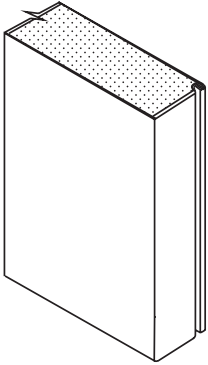

#### Standard Visible Seamless

##### HE Series Visible Seam Features

1. Full height mechanical interlock
2. Interlock filled with epoxy adhesive
3. Visible edge seam

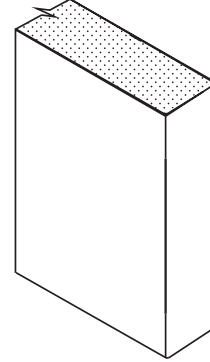

#### Optional Seamless Edges

##### HEF Series Seam Filled Features

1. Full height mechanical interlock
2. Interlock filled with epoxy adhesive
3. Seam epoxy filled and finished
4. No visible edge seam